

Complete Table of KWM Bronze Friction Bushing (American Made)

Order Number for bushing is SBB72.B57 Sample of the part Number KWM Bronze Bushing Refills Pkg. 20 pc.

SBB72. 01-026,032-049,055-072,086-117,138-147 \$ 5.50 Pkg. ... 6 to 11 \$ 5.25 Pkg. ... 12 or More \$ 5.00 Pkg.

SBB72.27-31,50-54,73-85,118-137 \$ 7.50 Pkg. ... 6 to 11 \$ 7.25 Pkg. ... 12 or More \$ 7.00 Pkg.

Z Pivot Diameter	B o r e	H D R R N	1.0		1.4					1.7	1.9			2.7					3.0	4.0
			1.2	1.8	1.8	2.7	3.5	4.7	5.9	5.9	1.8	2.7	3.5	1.8	2.7	3.5	4.7	5.9	8.7	8.7
			1.18	1.78	1.78	2.68	3.48	4.66	5.85	5.85	1.78	2.68	3.48	1.78	2.68	3.48	4.66	5.85	8.64	8.64
			I	II	II	III	IV	IVa	V	V	II	III	IV	II	III	IV	IVa	V	VI	VI
0.07-0.08	0.1		B55																	
0.10-0.12	0.15		B56																	
0.15-0.17	0.2		B01																	
0.19-0.21	0.25		B57																	
0.23-0.25	0.3		B02		B64						B86									
0.27-0.30	0.35		B58																	
0.32-0.35	0.4		B03		B08						B87									
0.38-0.40	0.45		B59																	
0.42-0.45	0.5		B04		B09						B32				B94					
0.48-0.50	0.55		B60																	
0.53-0.55	0.6		B05		B10						B33				B95					
0.57-0.60	0.7		B06		B11						B34				B96					
0.65-0.70	0.8		B07		B12						B35				B97					
0.75-0.80	0.9			B61	B13						B36				B98					
0.85-0.90	1.0			B62	B65	B14					B37				B99					
0.95-1.00	1.1			B63	B66	B15							B38		B100					
1.05-1.10	1.2					B16							B39		B101					
1.15-1.20	1.3					B17							B40		B102					
1.25-1.30	1.4					B18							B41		B103					
1.35-1.40	1.5					B19							B42		B104					
1.45-1.50	1.6					B20							B43		B105					
1.55-1.60	1.7					B67							B88		B106					
1.65-1.70	1.8					B21							B44		B107					
1.75-1.80	1.9					B68							B89		B108					
1.85-1.90	2.0						B22							B45		B109				
1.95-2.00	2.1						B69							B90		B110				
2.05-2.10	2.2						B23							B46		B111				
2.15-2.20	2.3						B70							B91		B112				
2.25-2.30	2.4						B24							B47		B113				
2.35-2.40	2.5						B71							B92		B114				
2.45-2.50	2.6						B25							B48		B115				
2.55-2.60	2.7						B72							B93		B116				
2.65-2.70	2.8						B26							B49		B117				
2.75-2.80	2.9							B138	B73	B80						B143				
2.85-2.90	3.0							B139	B27	B50						B144	B118			
2.95-3.05	3.2							B140	B28	B51						B145	B119			
3.10-3.25	3.4							B141	B74	B81						B146	B120			
3.30-3.45	3.6							B142	B29	B52						B147	B121			
3.55-3.65	3.8								B75	B82							B122			
3.75-3.85	4.0								B76	B83							B123			
3.90-4.05	4.2								B30	B53							B124			
4.15-4.25	4.4								B77	B84							B125			
4.35-4.45	4.6								B31	B54							B126			
4.55-4.65	4.8								B78	B85							B127			
4.75-4.85	5.0																	B128		
5.00-5.05	5.2																	B129		
5.15-5.25	5.4																	B130		
5.35-5.45	5.6																	B131		
5.55-5.65	5.8																	B132		
5.75-5.85	6.0																	B133		
5.95-6.05	6.2																		B134	
6.15-6.25	6.4																		B135	
6.35-6.45	6.6																		B136	
6.55-6.65	6.8																		B137	

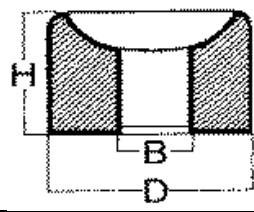

How to use this chart
 The numbers prefixed by the letter "B" such as B57 in the chart indicates the bushing number.
 The number serves as a refill number for various assortments.
 To select the correct bushing, first Measure the pivot, & find it size in the range of sizes shown in column Z. By reading across, you Will find the various bushing that Will fit the size pivot.
 Select the thickness of bushing by Referring to letter "H" & the correct diameter by the letter "D".
 After choosing the bushing, read Up the column to line "RN" which indicates the size reamer to Be used for the selected bushing.
 Reamers are identified by Roman numerals.

Prices Subject To Change Without Notice.