

# Complete Table of KWM Bronze Friction Bushing (American Made)

Order Number for bushing is SBB72.B57 Sample of the part Number KWM Bronze Bushing Refills Pkg. 20 pc.

SBB72. 01-026,032-049,055-072,086-117,138-147 \$ 5.00 Pkg. ... 6 to 11 \$ 4.75 Pkg. ... 12 or More \$ 4.50 Pkg.

SBB72.27-31,50-54,73-85,118-137 \$ 7.25 Pkg. ... 6 to 11 \$ 7.00 Pkg. ... 12 or More \$ 6.75 Pkg.

Z Pivot Diameter	B o r e	H D R R N	1.0		1.4					1.7	1.9			2.7					3.0	4.0
			1.2	1.8	1.8	2.7	3.5	4.7	5.9	5.9	1.8	2.7	3.5	1.8	2.7	3.5	4.7	5.9	8.7	8.7
			1.18	1.78	1.78	2.68	3.48	4.66	5.85	5.85	1.78	2.68	3.48	1.78	2.68	3.48	4.66	5.85	8.64	8.64
			I	II	II	III	IV	IVa	V	V	II	III	IV	II	III	IV	IVa	V	VI	VI
0.07-0.08	0.1		B55																	
0.10-0.12	0.15		B56																	
0.15-0.17	0.2		B01																	
0.19-0.21	0.25		B57																	
0.23-0.25	0.3		B02		B64						B86									
0.27-0.30	0.35		B58																	
0.32-0.35	0.4		B03		B08						B87									
0.38-0.40	0.45		B59																	
0.42-0.45	0.5		B04		B09						B32				B94					
0.48-0.50	0.55		B60																	
0.53-0.55	0.6		B05		B10						B33				B95					
0.57-0.60	0.7		B06		B11						B34				B96					
0.65-0.70	0.8		B07		B12						B35				B97					
0.75-0.80	0.9			B61	B13						B36				B98					
0.85-0.90	1.0			B62	B65	B14					B37				B99					
0.95-1.00	1.1			B63	B66	B15							B38		B100					
1.05-1.10	1.2					B16							B39		B101					
1.15-1.20	1.3					B17							B40		B102					
1.25-1.30	1.4					B18							B41		B103					
1.35-1.40	1.5					B19							B42		B104					
1.45-1.50	1.6					B20							B43		B105					
1.55-1.60	1.7					B21							B44		B106					
1.65-1.70	1.8					B22							B45		B107					
1.75-1.80	1.9					B23							B46		B108					
1.85-1.90	2.0					B24							B47		B109					
1.95-2.00	2.1					B25							B48		B110					
2.05-2.10	2.2					B26							B49		B111					
2.15-2.20	2.3					B27							B50		B112					
2.25-2.30	2.4					B28							B51		B113					
2.35-2.40	2.5					B29							B52		B114					
2.45-2.50	2.6					B30							B53		B115					
2.55-2.60	2.7					B31							B54		B116					
2.65-2.70	2.8					B32							B55		B117					
2.75-2.80	2.9					B33							B56		B118					
2.85-2.90	3.0					B34							B57		B119					
2.95-3.05	3.2					B35							B58		B120					
3.10-3.25	3.4					B36							B59		B121					
3.30-3.45	3.6					B37							B60		B122					
3.55-3.65	3.8					B38							B61		B123					
3.75-3.85	4.0					B39							B62		B124					
3.90-4.05	4.2					B40							B63		B125					
4.15-4.25	4.4					B41							B64		B126					
4.35-4.45	4.6					B42							B65		B127					
4.55-4.65	4.8					B43							B66							
4.75-4.85	5.0					B44							B67							B128
5.00-5.05	5.2					B45							B68							B129
5.15-5.25	5.4					B46							B69							B130
5.35-5.45	5.6					B47							B70							B131
5.55-5.65	5.8					B48							B71							B132
5.75-5.85	6.0					B49							B72							B133
5.95-6.05	6.2					B50							B73							B134
6.15-6.25	6.4					B51							B74							B135
6.35-6.45	6.6					B52							B75							B136
6.55-6.65	6.8					B53							B76							B137

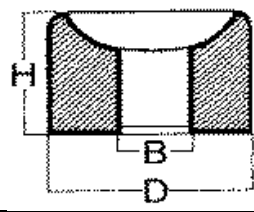

**How to use this chart**  
 The numbers prefixed by the letter "B" such as B57 in the chart indicates the bushing number.  
 The number serves as a refill number for various assortments.  
 To select the correct bushing, first Measure the pivot, & find it size in the range of sizes shown in column Z. By reading across, you Will find the various bushing that Will fit the size pivot.  
 Select the thickness of bushing by Referring to letter "H" & the correct diameter by the letter "D".  
 After choosing the bushing, read Up the column to line "RN" which indicates the size reamer to Be used for the selected bushing.  
 Reamers are identified by Roman numerals.

Prices Subject To Change Without Notice.